

NISSAN
FORKLIFT

1F4 Series

Pneumatic Tire / Engine-powered Models **3.5–5.0** ton



Super Tough; Super Performance

Durability, reliability, performance and quality: automobile or forklift, Nissan sets the standard for design and engineering quality in everything we do.

Drawing on more than a half-century of experience in producing outstanding forklifts, Nissan built on the strong 1F series to create a bigger, tougher family of forklifts in the 3.5 to 5.0 ton range, created to meet the real needs of operators around the globe: the 1F4.

The 1F4 builds on a pyramid of key concepts—toughness, comfort and safety and high productivity—to provide lowered cost over the total vehicle lifecycle. Super tough; super performance: the new 1F4 Series from Nissan Forklift.

1F4

Series



The creation of the new 1F4 is founded on three key concepts:

Key Concept 1: Toughness—the sturdiness to handle big jobs and keep on working

Key Concept 2: Comfort and Safety—helping the operator to feel more secure while reducing fatigue

Key Concept 3: High Productivity—the ability for machine and operator alike to keep on going, smart functions and reduced downtime all combine for higher productivity

The Result: Reduced Total Lifecycle Cost



Super Tough; Super Performance

NISSAN FORKLIFT 1F4 Series



Key Concept 1:

Toughness

Built to take on the most demanding work environments: the tough, reliable 1F4. With the durability and reliability to handle the toughest situations, such as rough outside work areas where dust and debris can be a constant hazard, it's built with heavy forklift users in mind.

The 1F4 was created by carefully listening to customer requests and market demands. It's a forklift that answers today's needs: a truly tough, anytime, anywhere, do-it-all forklift.

Reinforced Components

Big New Final Drive

The final drive design provides the durability and reliability for a variety of operations, even on rough roads.

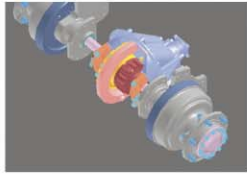

Enhanced Brakes

Larger brake size means improved braking conditions (option on 4-ton model). A standard hydraulic booster means greater braking force with less effort.

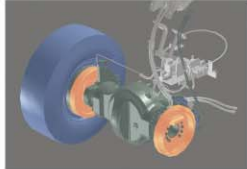

Sturdy Mast

The highly-rigid mast has the strength to carry large horizontal or vertical loads securely, with a choice of accessories to meet specific work objectives.





Superior Shielding from the Surroundings

Keeping Intake Air Clean

The use of a cyclone air cleaner has doubled the dust-holding capacity—providing the engine protection needed for long work periods in dusty environments. Seals have also been improved.



Protected Ball Joints

The steering link ball joints (blue in illustration) are equipped with dust covers and other improvements as standard to shield them from dust and debris, increasing reliability. The rear axle (green) now features a unified construction for greater strength.

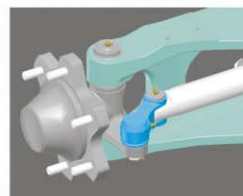

VCM (Vehicle Control Module)

VCM durability has been increased through the use of waterproof connectors and enclosures meeting the IP65 standard for dust- and water-tightness.



Key Concept 2:

Comfort & Safety

Building on the tough base of the 1F4 concept, Nissan next added the important ingredients of operator comfort and safety. Superior visibility is enhanced by a number of ergonomically-designed, safety-conscious functions to help create a stress-free working environment—minimizing fatigue and letting the operator concentrate throughout the shift.

Smart, Safe, Easy-Operating Controls

1 Easy Access

A wide, non-skid steel step and ample legroom provides easy step in/step out access—and maximum seating comfort.



2 Parking Brake Warning Buzzer

An automobile-style parking brake features a warning buzzer that sounds when the operator leaves the seat without setting the parking brake.



3 Powertrain Float Reduces Vibrations

An automobile-style floating powertrain and rigid frame and chassis reduce the transmission of vibrations to the operator, helping to provide hours of comfortable operation.

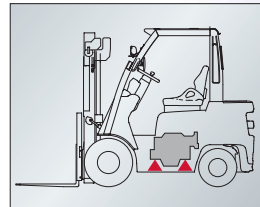

4 Multifunctional LCD Meter

The large, easy-to-see meter lets the operator check on all aspects of the forklift's operational status at a single glance.

- | | | |
|--|--------------------|---|
| A Multipurpose warning | D Charge warning | H Fuel gauge |
| B Glow plug indicator (Diesel)
Check engine warning
(Gasoline/LPG) | E Brake warning | I Water temperature gauge |
| C Oil pressure warning | F Seatbelt warning | J Multifunction display: hour meter, clock/calendar,
speedometer, service reminder, warning indicators,
error codes |
| G Directional indicator | | |

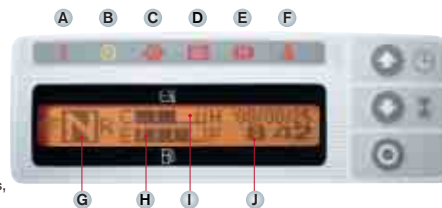

*Air cleaner clogging warning is available as an option.

5 Mast Lock System

The Mast Lock System, standard on all models, automatically locks all lifting and tilting functions when the operator leaves the seat.



6 Adjustable Sliding Seat

The seat slides through a full 150mm fore and aft, providing easy adjustment for every operator height.

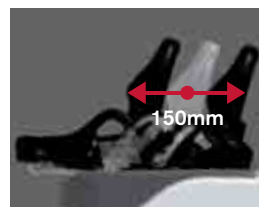

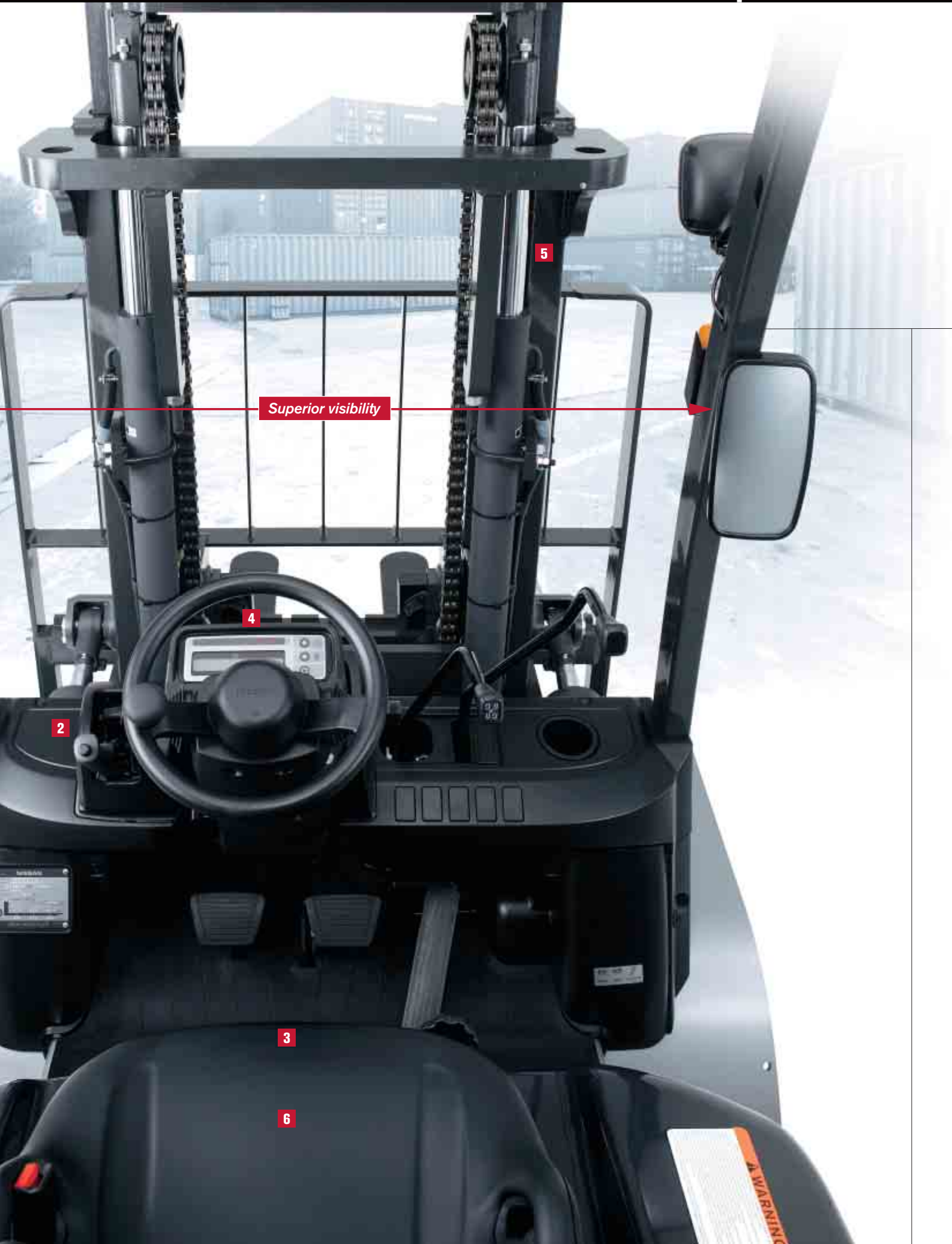

2

4

3

6

5

Superior visibility

WARNING

Key Concept 3:

High Productivity

The 1F4 series has been designed and built to provide superior performance, whether the work requires rapid travel and lift speeds, or slow speeds and precise control. Whatever it is that you need to handle, powerful Nissan engines, high-capacity hydraulic pumps and built-in stability all ensure that the 1F4 is one of the most productive forklifts in its class.

Control with Confidence

Easy-operating Levers

The forward-reverse lever swings through a smaller arc than previous models, meaning less effort and total time spent on this basic, often-performed function. An automobile-style light and auto-return turn-signal lever add to the convenience and efficiency.



Steering Synchronizer

(Option)

A sensor checks steering and tire angles so the steering knob always returns to the original position. This function helps to ensure consistent coordination of steering wheel and tires, for precise steering.

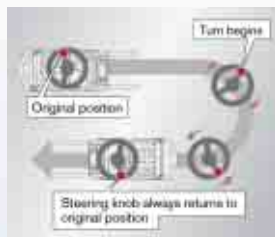

FINGERTIP Control Lever (Option)

The optional fingertip control system uses electro-hydraulic levers for control of travel direction, horn, tilt and lift operations with just a slight touch of the finger, providing greater ergonomics and productivity. Both single and double control levers are available.

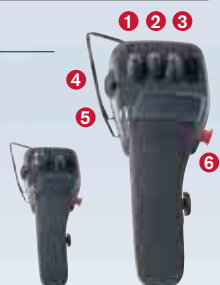

- ① Lift and Lower
- ② Tilt
- ③ Lever for Attachment
- ④ F/R Lever
- ⑤ Horn Switch
- ⑥ Emergency Stop

Single Lever Double Lever

Two-speed Torque Converter (Option)

The optional two-speed torque converter provides improved running and acceleration performance. Automated shifting means an optimal shift schedule and reduced shifting shock.



The Result:

Reduced Total Lifecycle Cost

Add easy maintenance to the three key concepts of the 1F4—Toughness, Comfort and Safety and High Productivity—and the result is lowered cost throughout the life of the forklift. With the 1F4, simplified access for vehicle service helps ensure that maintenance times are kept to a minimum.



Cost Effective Maintenance

Easy Engine Access

Access to the engine has never been easier, with a wide-opening hood that simplifies operations. One-touch removal of the floorboard and side panels allows for quick service operations and reduced downtime—and no tools are required.



Five-piece Overhead Guard

The overhead guard is made up of five separate pieces, for easy, cost-effective replacement of only the individual sections needed.



Engines with Higher Productivity and Low Emissions

TD42 Diesel Engine **NEW**

The new TD42 diesel engine provides the means to get tough jobs done smoothly and efficiently. In addition, the Quick Glow System provides greatly improved starting in cold weather.



TB45 Gasoline/LPG Engine **NEW**

The new TB45 gasoline/LPG engine features ECCS (Electronic Concentrated Control System) and a three-way catalytic converter as standard equipment. This combination reduces toxic components in the exhaust gas. ECCS helps to increase maximum output and lifting speed. Selecting Eco mode on the Power/Eco Selector reduces noise, increases fuel efficiency and decreases tire wear.



Nissan Green Program

Nissan's environmental philosophy can be described as "a symbiosis of people, vehicles and nature." It is our ideal for a sustainable mobile society now, and our goal for the future. We launched the Nissan Green Program 2010 with specific objectives to realize the goal, and we are diligently making concerted efforts to reduce environmental impact at every stage of the vehicle life cycle, and in our corporate activities.

Make it Yours: a Wide Choice of Options and Attachments

These are just a few of the many options and attachments available for the 1F4 Series. For more information, please contact your local Authorized Nissan Dealer.



Smooth-run System

Two different types of accumulators absorb the shocks transmitted from the road surface, making both load handling and travel smoother. This is an extra benefit when working with delicate loads on rough surfaces.



LPG Swing-down Bracket with Tank and Hose

This ergonomically-designed swing-down bracket greatly assists in the lifting and lowering of tanks. The design also ensures excellent rearward visibility (available on all LPG models).



Rain Guard (Resin Type)

While offering good upward visibility, this durable rain guard protects the operator in inclement weather.



Single Control Lever

Nissan's original Single Control Lever allows for simultaneous lifting and tilting operations, for greater productivity (double control levers are also available).



Tilt Leveling System

A simple press of a button on the mast control lever brings the forks automatically to the horizontal position—a great aid for new operators.



Double Tires

Double tires are available for greater stability when lifting loads high.



Hinged Fork

Securely holds and carries long loads, such as lumber or steel pipes.



Fork Positioner

Provides accurate positioning of the forks with the load.



Side Shift

This hook-on type side shifter provides right and left fork movement for accurate stacking.



Rotating Fork

Full 360° rotation, for faster work and easier load discharge.



Roll Clamp

Easy, efficient clamping and rotation of cylindrical loads.

Specifications Pneumatic Tire/Engine-powered Models 3.5-5.0 ton

Model	W1F4A (F) 35U J1F4A (F) 35DU/LU	W1F4A (F) 40U J1F4A (F) 40DU/LU	W1F4A (F) 45U J1F4A (F) 45DU/LU	WG1F4A (F) 50U JG1F4A (F) 50DU/LU	
Engine Type	TD42, TB45	TD42, TB45	TD42, TB45	TD42, TB45	
Load Capacity	t	3.5	4.0	4.5	5.0
Load Center	mm	600	600	600	600
Max. Fork Height (standard mast)	mm	3000	3000	3000	3000
Overall Width	mm	1490	1490	1490	1490
Overall Length (length to fork face)	mm	3095	3130	3210	3340
Overall Height (overhead guard height)	mm	2250	2250	2250	2250
Turning Radius (outside)	mm	2720	2750	2800	2935

Engine

Model	Nissan TD42	Nissan TB45	
Displacement	cc	4169	4478
Rated Output	kW/rpm	61/2400	63.9/2450
Rated Torque	N-m/rpm	245/1800	288/1600

Option Availability

 Standard Options

Item		J(G)1F4 35-50 Gasoline/LPG		W(G)1F4 35-50 Diesel
		Dual	LPG	
Truck management	VCM			
Powertrain	Powertrain floating			
	ECCS			
	Speed Selector			
	Power / Eco Selector			
	Radiator screen			
	3-way catalytic muffler			
Air cleaner	Overhead exhaust muffler			
	Cyclone air cleaner			
Special application	Donaldson-type air cleaner			
	Rustproof specification			
LPG system (Dual fuel) Swing-down	Dustproof specification			
	Dust cover			
	Low noise specification			
	Cold area specification			
Instruments	Tank + Bracket + Hose			
	Bracket + Hose			
	Bracket only			
Warning buzzer	Without Tank + Bracket + Hose			
	Multifunctional LCD Meter *			
Light	Back-up buzzer			
	Parking brake warning buzzer			
	Head lights (without guard)			
	Rear combination lamps			
Tires	Rear working light			
	Rotating light (yellow)			
	J-lug tires (textile)			
Body	Solid tires			
	Double tires			
	Rain guard (vinyl type)			
	Rain guard (resin type)			
	Canvas cabin			
Seat	Rearview mirrors (both sides)			
	Windshield			
Mast	Restraint seat with suspension			
	Without seat			
	2W mast			
	3F mast			
	Without mast			
	Tilt cylinder cover			
	Tilt cylinder boot			
Tilt Leveling System				
Steering system	Small-diameter steering wheel with tilt adjustment			
	Steering Synchronizer			
Hydraulic control system	2 spool valve			
	3 spool valve			
	4 spool valve			
	Single control lever			
	Double control lever			
	FINGERTIP control (single type)			
	FINGERTIP control (double type)			
	3 spool piping to carriage			
	4 spool piping to carriage			
	Smooth-run System			

*Air cleaner clogging warning is available as an option.



1F4 4.0 ton



1F4 4.5 ton

Nissan Full Lineup That Exceeds All Expectations



Nissan Motor Co., Ltd.

Nissan Motor Co., Ltd. reserves the right to make any changes without notice concerning colors, equipment, or specifications detailed in this brochure, or to discontinue individual models. The colors of vehicles delivered may differ slightly from those in this brochure. The specifications vary for different countries depending on local market conditions. Please consult your local dealer to ensure that the vehicle delivered accords with your expectations.